

Community Controls Stinger™ Type: 360ODD31V

FCC ID: SU7360ODD31V

This device complies with Part 15 of the FCC Rules.

Operation is subject to the following two conditions:

- (1) This device may not cause harmful interference, and
- (2) this device must accept interference received, including interference that may cause undesired operation.

DO NOT let children use the garage door transmitter without adult supervision. Children can injure themselves or others with the garage door.

Notice

Any changes or modifications to Community Controls equipment not expressly approved by Community Controls could void the manufacturer's warranty and could void the user's authority to operate the equipment.

WARRANTY

The warranty period of Community Controls Stinger™ transmitters is 24 months, beginning from the manufacturing date of the transmitter. During this period, if the product does not operate correctly, due to a defective component, the product will be repaired or replaced at the sole discretion of Community Controls. The warranty does not extend to the transmitter case which can be damaged by conditions outside of the control of Community Controls, or to battery life.



2500 South 3850 West, Suite A • Salt Lake City, UT 84120
800-284-2837 • 800-867-3637 Fax
www.communitycontrols.com

Manual - 360 1 Button

Community
Controls



TRANSMITTER

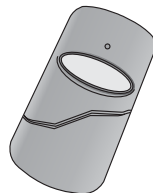

*Thank you for choosing a Community Controls product.
Please read this manual carefully before using the product.*

Made in China. Copyright © 2010 Community Controls

CONTENTS

1 - TRANSMITTER OVERVIEW

- 1A - General information
- 1B - Technical specifications
- 1C - Main components

2 - PROGRAMMING

3 - OPERATION

4 - BATTERY ACCESS

5 - TROUBLESHOOTING

1A - General information

The Community Controls - Stinger™ Transmitter is a very small (1-5/8" x 3" x 1/2") visor style wireless transmitter operating at 360 MHz. The Stinger™ achieves its small size by using state-of-the-art, surface mount components. It has been designed for use with and is compatible with overhead door company garage door openers operating at 360 MHz.

2 - CODING

Set the nine-digit toggle code switch to match the code set in the receiver. Access to the Stinger™'s toggle code switch is achieved by sliding down the front cover. Move switches using a small pointed object, such as a paper clip, gently switching the small switches to either the + or - position. (In Detail below, switches 1, 3, 5, 6, and 8 are in the + position, switches 2, 4, 7 and 9 are in the - position. When complete, reinstall battery and side front cover back into its original position.

3- OPERATION

Once the codes are set to match the transmitter codes, you may test the system. Ensure the gate or door is visible and clear before testing.

Step 1. Push the Stinger™'s button from a distance of about ten feet. If the receiver activates, the switches are properly matched.

Step 2. Test the transmitter from several locations to discover any "blind spots" caused by interference.

4 - BATTERY ACCESS

Slide front cover down to reach battery compartment. Attend to proper polarity when installing or replacing battery. See "coding" for proper removal and replacement of cover.

5 - TROUBLESHOOTING

PROBLEM	SOLUTION
The system does not receive the transmitter signal. The transmitter LED will not light.	Ensure clear plastic battery insulator has been removed. Replace the transmitter battery.
The system does not receive the transmitter signal. The transmitter LED is ON.	Check to ensure the transmitter switches are coded to match your system receiver.
The operating range is reduced.	Replace the transmitter battery.

The A23 battery has a shelf life of about 1 year. The product fully complies with Part 15 of the FCC Regulations.

1B - Technical Specifications

Operating frequency	360 MHz
Number of buttons	1
Battery:	1 ea. 12V A23
Number combinations:	1 billion
Operating temperature:	-20°F – 100°F
Overall dimensions:	1/2" x 3" x 1-5/8"
Weight:	1 oz.

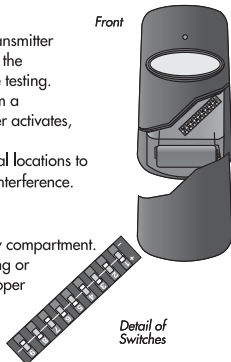

1C - Main components

