

INSTRUCTIONS FOR RADIO CONTROL OPERATOR SINGLE ENTRY TRANSMITTER MODEL O220

Read the following instructions thoroughly before using transmitter.

This transmitter must be adjusted so that the coding switches match the coding switches on your present operating transmitter or receiver.

FCC Regulation: This device complies with FCC Rules Part 15. Operation is subject to the following two conditions: 1) This device may not cause harmful interference. 2) This device must accept an interference that may cause an undesired operation. Transmitter distance may vary due to circumstances beyond our control.

INSTRUCTION FOR SINGLE ENTRY TRANSMITTER

1. Remove the transmitter cover

Remove the access cover from the front of the transmitter by sliding the cover away from the top of the transmitter (**Figure A**). This will expose the battery and the dip switches. The code can be changed using a small screwdriver.

DoorOpenersandMore.com

2. Setting the code

You may set your transmitter to any code you desire, but be sure the code you set matches on both your transmitter and receiver.

There are 9 dip switches on your transmitter, each of which can be placed in three different positions(+,0,-). DO NOT set all switches in same position, such as all +, all -, or all zero (**Figure B**). **WARNING:** No other adjustments should be made inside the transmitter.

Now that you have selected your personal code, replace the transmitter cover.

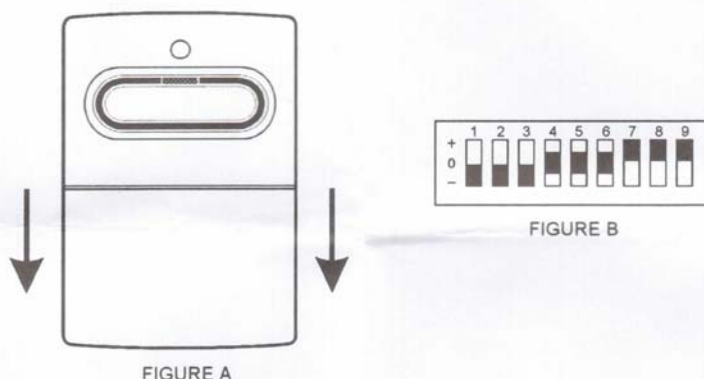

WARNING!

Changes or modifications not expressly approved in writing may void the user's authority to operate this equipment.